

Z415 BODY ASSEMBLY WITH "TYPE S" STRAINER

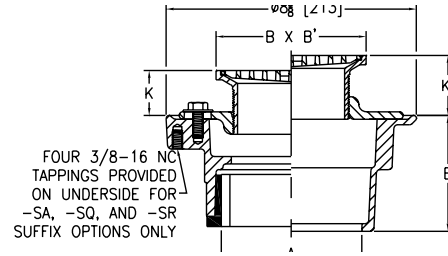

ENGINEERING SPECIFICATION

Zurn ZN415S floor and shower drain features Dura-Coated cast iron body with bottom outlet, combination invertible membrane clamp and adjustable collar with seepage slots, and "TYPE S" polished, nickel bronze, square heel-proof, light-duty strainer.



Strainer Designation	Dimensions in inches [mm]						Str. Open Area sq in [cm ²]	Approximate Weight lb [kg]
	A Pipe Size	B x B' Strainer Top Size	K		K'			
			Min.	Max.	Min.	Max.		
-5S	2 [51], 3 [76]	5 x 5 [127]	1 [25]	1-19/32 [40]	1-1/4 [32]	2-3/8 [60]	19 [122]	12 [5]
-6S	2 [51], 3 [76], 4 [102]	6 x 6 [152]		1-27/32 [47]	1-13/32 [36]	2-19/32 [66]	13 [84]	13 [6]
-7S			7 x 7 [178]	1-7/8 [48]	1-3/8 [35]	2-5/8 [67]	21 [135]	14 [6]
-8S	3 [76], 4 [102]	8 x 8 [203]	1-3/4 [44]		28 [181]		15 [7]	
-10S	6 [152]	10 x 10 [254]				21 [10]		

PREFIXES	DESCRIPTION	STRAINER DESIG.	PIPE SIZE	LIST PRICE
ZN415*	D.C.C.I. Body Assembly with Polished Nickel Bronze Top	-5S	2", 3"	645.00
		-6S	2", 3", 4"	719.00
		-7S	2", 3", 4"	863.00
		-8S	3", 4"	1,042.00
		-10S	6"	2,198.00
ZB415	D.C.C.I. Body Assembly with Polished Bronze Top	-5S	2", 3"	592.00
		-6S	2", 3", 4"	680.00
		-7S	2", 3", 4"	807.00
		-8S	3", 4"	946.00
		-10S	6"	2,088.00
Z415	D.C.C.I. Body Assembly ONLY (add "-L/Top" to product sku)	No Strainer	2", 3", 4"	194.00
			6"	739.00

OUTLETS (SPECIFY PIPE SIZE IN INCHES AND TYPE OF OUTLET)				
OUTLET TYPE		PIPE SIZE/ OUTLET TYPE	E BODY HT. DIM.	ADD
IC	Inside Caulk	2IC, 3IC, 4IC	4-13/16"	N/C
IG	Inside Gasket	2IG, 3IG, 4IG	4-13/16"	N/C
IP	Threaded	2IP	2-7/16"	80.00
		3IP	2-3/4"	80.00
		4IP	2-13/16"	80.00
		6IP	2-7/8"	80.00
NH	No-Hub	2NH, 3NH, 4NH	3-13/16"	N/C
NL	Neo-Loc	2NL, 3NL, 4NL	3-7/8"	N/C

SUFFIXES		ADD
-AR	Acid Resisting Epoxy Coated Cast Iron	171.00
-CP	Chrome-Plated Bronze Top	26.00
-G	Galvanized Cast Iron	198.00
-HD	Heavy-Duty Grate (ZN 6" x 6" only)	206.00
-OF	Oval Funnel (6", 7", 8", 10" strainers only) (See Z329-7)	-
-P	Trap Primer Connection (1/2")	N/C
Ⓢ -PC	Protective Cover	64.00
Ⓢ -SA	Stabilizer Assembly (See Z1035)	138.00
Ⓢ -SQ	Stabilizer Q-Deck (See Z1035-Q)	184.00
Ⓢ -TC	Neo-Loc Test Cap Gasket (2", 3", 4" NL Bottom Outlet Only)	24.00
-U	1"-3" High Extension Adapter (See Z400-U)	D.C. 140.00
		Galv. 306.00
	For each additional 1" above 3"	98.00
-V	Backwater Valve (Not Available with -Y)	380.00
-VP	Vandal-Proof Secured Top	58.00
-Y	Sediment Bucket (Not Available with -V)	109.00
-4	4" Diameter Funnel (See Z328)	-
-90	90° Threaded Side Outlet Body Assembly (2" and 3" Only)	219.00

BEST SELLERS	LIST PRICE
ZB415-2NH-5S-CP	618.00
ZN415-2NH-5S-P	645.00
ZB415-2NL-5S	592.00
ZB415-3NH-6S	680.00
ZB415-3NH-6S-P	680.00
ZB415-3NL-5S	592.00
ZN415-3NL-5S-P	645.00
ZB415-3NL-6S-P	680.00
ZN415-2NL-7S	863.00
ZB415-3NL-8S	946.00
ZN415-3NH-8S	1,042.00

Supplied By:



877-903-7246

www.commercialplumbingsupply.com

*Regularly furnished unless otherwise specified.

Items designated as Best Sellers are most specified and are generally in stock for shipment.

Ⓢ This symbol denotes a product that is engineered to reduce installation and rework time.

For additional product information, please visit www.zurn.com

INTRO ROOF DRAINS FLOOR DRAINS T, P, BW VALVES INTERCEPTORS CARRIERS HYDRANTS CLEANOUTS W/HA SS DRAINS FAB SS DRAINS SAN-FLOOR TECH INFO